

## Livorsi 975 vs. Livorsi 950 Comparison

- 975 tab is 12" wide vs the 950 tab which is 14" thus gaining 4 inches of transom space when moving tabs outward on each side.
- The 975 cutaway is more aggressive and will gain you another 2 inches (1" each side) to clear motors and not disrupt props.
- 3 inches clearance gained for each side, total of 6 inches overall to clear props and minimize cavitation for engine cooling.
- Transom plates are smaller to give you more adjustability on the transom.

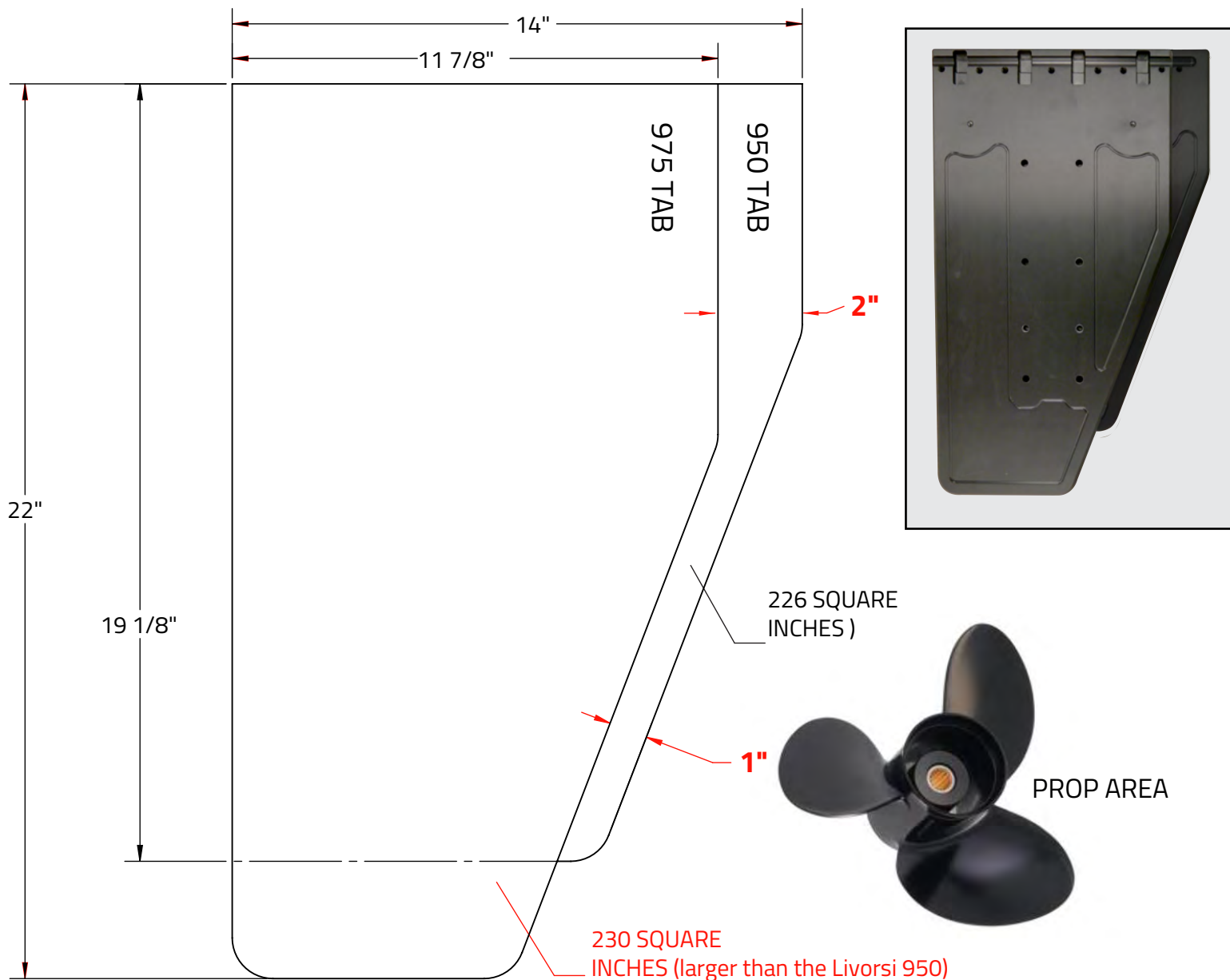

- Tabs are hard anodized billet aluminum compared to cast aluminum and painted.
- Standard equipment in Contender, Yellowfin, Blackwater, Deep Impact, Renegade, Statement, Military and many others.



### 3 inches clearance gained for each side, total of 6 inches overall to clear props and minimize cavitation for engine cooling

- Additional motor clearance for narrow transom boats
- Wider motor separation allowing greater propeller bite and improved docking maneuvering

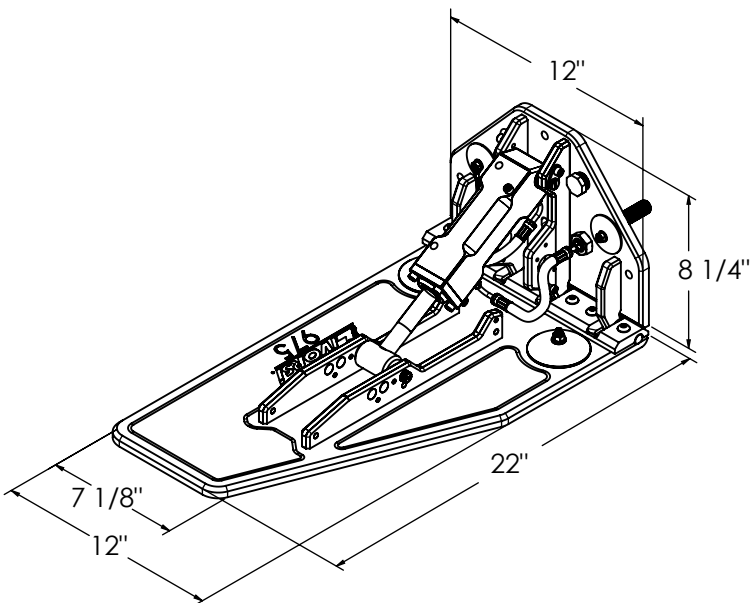
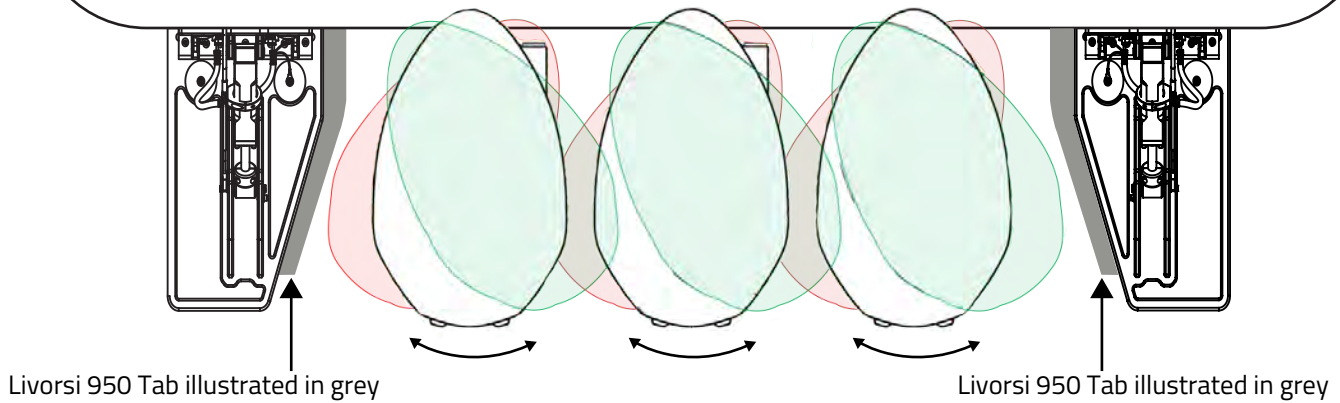

## DIMENSIONS

